

Date: 10/31/2018

Subject: RAC Reduced Fan Operation, Cooling Thermo Off

Models: AR\*\*\*S\*\*\*\*\*/CV

## RAC Reduced Fan Operation Option Setting (Cooling Mode)

Samsung RAC models have an option for reduced fan speed (ultra low) while in cooling mode and set temperature has been reached (Thermo OFF). This option should only be enabled when sensing temperature externally via wired controller or external temperature sensor (MRW-TA). The indoor unit product option code should be modified according to the chart and steps listed below.

Product	MODEL NAME	MODEL NAME	Option Code (factory default)	Option Code (for reduced fan)
WIND-FREE	AR09MSWXCWK/CV	AR09MSWXCWKNCV	011E25-17EA4A-271920-3724D4	011E25-17EA4A-271920-3724D6
	AR12MSWXCWK/CV	AR12MSWXCWKNCV	011E25-17EA6B-272328-3714D4	011E25-17EA6B-272328-3714D6
	AR18MSWXCWK/CV	AR18MSWXCWKNCV	011825-16EA4B-27343C-3717DC	011825-16EA4B-27343C-3717DE
	AR24MSWXCWK/CV	AR24MSWXCWKNCV	011825-15EAAD-273D50-3717DC	011825-15EAAD-273D50-3717DE
MAX HEAT	AR09KSWSPWK/CV	AR09KSWSPWKNCV	010025-196A67-271920-37163E	010025-196A67-271920-37163E
	AR12KSWSPWK/CV	AR12KSWSPWKNCV	010025-176A89-272328-37183E	010025-176A89-272328-37183E
	AR18NSWSPWK/CV	AR18NSWSPWKNCV	010025-166A5B-27323C-37163C	010025-166A5B-27323C-37163E
	AR24NSWSPWK/CV	AR24NSWSPWKNCV	010025-156ABD-273D4F-37163C	010025-156ABD-273D4F-37163E
SMART PEARL	AR09KSWDHWK/CV	AR09KSWDHWKNCV	011025-156ABD-271A25-370934	011025-156ABD-271A25-370936
	AR12KSWDHWK/CV	AR12KSWDHWKNCV	011025-166ABD-272328-370934	011025-166ABD-272328-370936
SMART WHISPER	AR09KSWSJWK/CV	AR09KSWSJWKNCV	010025-176A89-271920-370534	010025-176A89-271920-370536
	AR12KSWSJWK/CV	AR12KSWSJWKNCV	010025-166ABA-272328-370634	010025-166ABA-272328-370636
	AR18KSWSJWK/CV	AR18KSWSJWKNCV	010025-176A38-27323C-371634	010025-176A38-27323C-371636
	AR24KSWSJWK/CV	AR24KSWSJWKNCV	010025-156ABD-273D50-370734	010025-156ABD-273D50-370736
QUANTUM	AR09KSFPDWQ/CV	AR09KSFPDWQNCV	014025-16423B-271A20-371984	014025-16423B-271A20-371986
	AR12KSFPDWQ/CV	AR12KSFPDWQNCV	014025-16424C-272328-371A84	014025-16424C-272328-371A86
	AR18KSFPDWQ/CV	AR18KSFPDWQNCV	014025-18625C-27353E-372584	014025-18625C-27353E-372586
	AR24KSFPDWQ/CV	AR24KSFPDWQNCV	014025-16629D-274046-371584	014025-16629D-274046-371586

The product option code can be set with the wireless remote controller that comes standard with the unit or through an optional wired controller.

### Product Option Code Modification Example

Model: AR09MSWXCWK/CV (Wind-Free™)

Factory option code: 011E25-17EA4A-271920-3724D4

New option code (for reduced fan operation): 011E25-17EA4A-271920-3724D6

### Setting option code: 20 segment Wireless Controller

NOTE: When using a 20 segment wireless remote to enter the product option code, do not enter the four page numbers (displayed in red in the following example)

**Example:** 011E25-17EA4A-271920-3724D6

1. To enter service mode, remove the batteries and wait for the screen to go blank. While holding the temperature up and down buttons, replace the batteries.
2. Use the FAN DOWN button to adjust the segment on the left and the FAN UP button to adjust the segment on the right to enter code into the wireless controller as shown on the images above.
3. Press MODE to advance to the next page (noted by "Auto", "Cool", "Dry", "Fan", "Heat", "ON", and "OFF").
4. Refer to installation and training manuals for full programming instructions when using a wireless controller.
5. Once the numbers shown above are entered into the controller, press the power button several times while pointing remote at the indoor unit.
6. All 20 segments must be entered as shown above to prevent undesired programming and operation.
7. Remove batteries. After the screen goes blank, replace batteries and cover to return to normal operation.

### Setting option code: 20 segment Wireless Controller (continued)

NOTE: When using a 20 segment wireless remote to enter the product option code, do not enter the four page numbers (displayed in red in the following example)

Example: 011E25-17EA4A-271920-3724D6

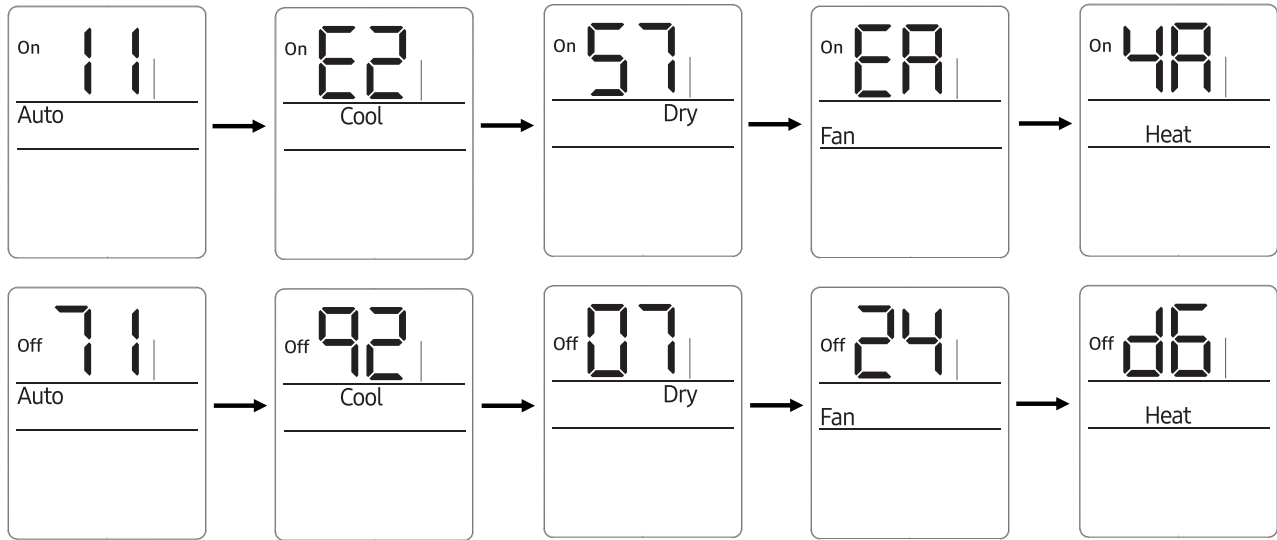

### Setting option code: MWR-WH00/MWR-WH02 wired controller

1. For MWR-WH00 / MWR-WH02: Hold FILTER RESET and TEMP for 5 seconds to enter service settings mode ("1" will display). Menu 1 is where indoor unit option codes can be reviewed/changed. Press SET.
2. Press the up arrow button and down arrow buttons to change the value of the flashing segment
3. Press SET arrow button to advance to the next segment.
4. Press MODE to go to the next page. Pages are represented with a "0", "1", "2", and "3" as the first segment.
5. After the code has been entered, scroll through all 4 pages to verify that the code was entered correctly.
6. Press the power button (above the fan up button) to send the code to the indoor unit.

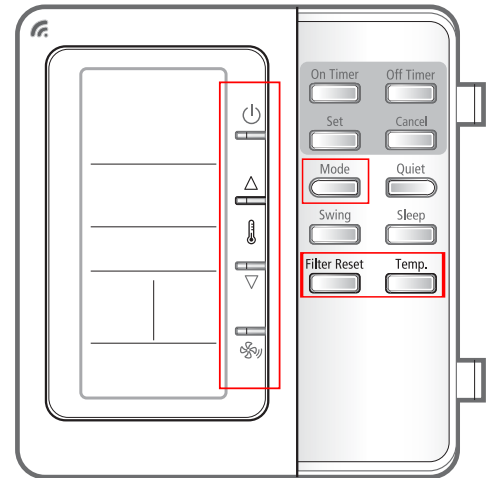

### Setting option code: MWR-WH00/MWR-WH02 wired controller

Example: 011E25-17EA4A-271920-3724D6

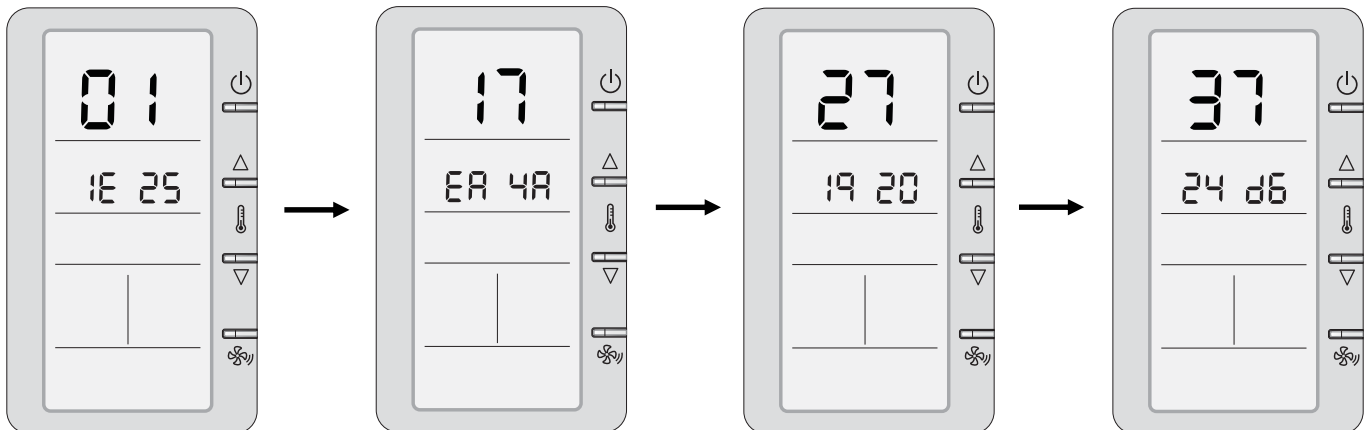

## Setting option code: MWR-WE13 wired controller

Example: 011E25-17EA4A-271920-3724D6

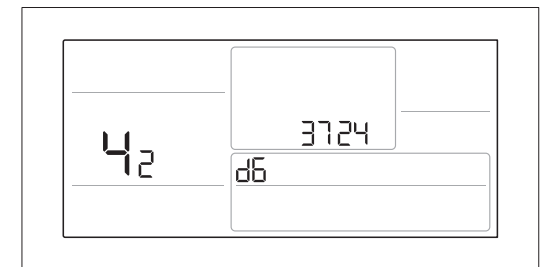
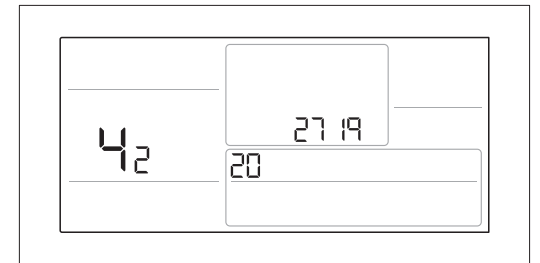
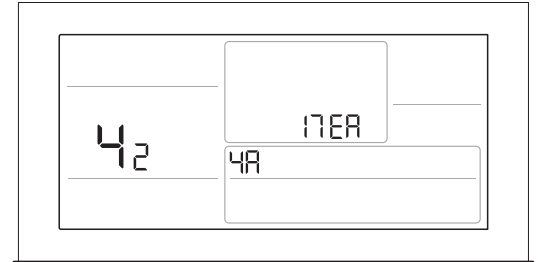
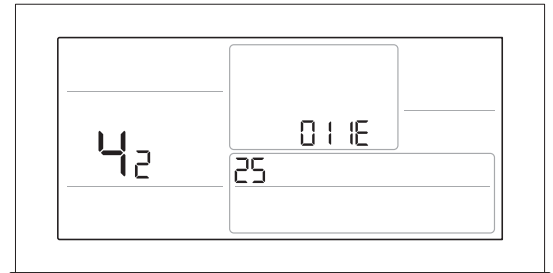
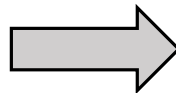
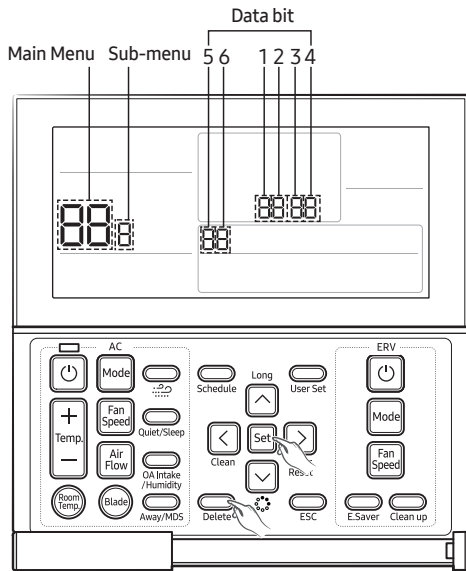

1. Hold SET and DELETE for 5 seconds to enter service settings mode.
2. Press the up arrow button, select Main Menu 4.
3. Press the right arrow button to advance.
4. Press the up arrow button to select sub menu 2.
5. Press the right arrow to advance.
6. Enter the code above into the data bit section using the up, down, and right arrow buttons.
7. Press the right arrow button to advance.
8. Once entered, press SET to save.
9. Press ESC twice to exit the settings section.