

Samsung RAC models listed below manufactured before 2/1/2017 do not support connection to Samsung central control options. Systems manufactured after 2/1/2017 will have updated firmware that supports connection to central control options provided by Samsung HVAC. Refer to pages 2 and 3 of this document for required components and diagrams to connect RAC systems to central control options.

### Applicable units

Series/System Name	Model Number	
	Indoor	Outdoor
Smart Pearl	AR09KSWDHWKN	AR09KSWDHWKX
	AR12KSWDHWKN	AR12KSWDHWKX
Smart Whisper	AR09KSWSJWKN	AR09KSWSJWKX
	AR12KSWSJWKN	AR12KSWSJWKX
	AR18KSWSJWKN	AR18KSWSJWKX
	AR24KSWSJWKN	AR24KSWSJWKX
Quantum	AR09KSFPDWQN	AR09KSFPDWQX
	AR12KSFPDWQN	AR12KSFPDWQX
	AR18KSFPDWQN	AR18KSFPDWQX
	AR24KSFPDWQN	AR24KSFPDWQX
Max Heat RAC	AR09KSWSPWKN	AR09KSWSPWKX
	AR12KSWSPWKN	AR12KSWSPWKX
	AR18NSWSPWKN	AR18NSWSPWKX
	AR24NSWSPWKN	AR24NSWSPWKX
Wind Free RAC	AR09MSWXCWKN	AR09MSWXCWKX
	AR12MSWXCWKN	AR12MSWXCWKX
	AR18NSWXCWKN	AR18NSWXCWKX
	AR24NSWXCWKN	AR24NSWXCWKX

To determine the date of manufacture, please refer to the serial number tag on your unit. The serial number sticker will note the date of manufacture. If you are not at the unit to see the tag but know the serial number, below are details how to determine date of manufacture based on the serial number.

Segment 8		Segment 9	
Year		Month	
L	2006	1	January
P	2007	2	February
Q	2008	3	March
S	2009	4	April
Z	2010	5	May
B	2011	6	June
C	2012	7	July
D	2013	8	August
F	2014	9	September
G	2015	A	October
H	2016	B	November
J	2017	C	December

### Serial number details

The eighth and ninth segments of the serial note the year and month of manufacture.

### Example

Outdoor unit serial number: 0E3EPADJ200300W

J = 2017

2 = February

### Required components

- Systems connecting to DVM S Central Controls (NASA): MIM-N01 interface module, DB93-11412A sub-PCB, and DB93-11405A sub-PCB harness
- Systems connecting to DVM Plus Central Controls (non-NASA): MIM-B13D interface module, DB93-11412A sub-PCB, and DB93-11405A sub-PCB harness

Samsung RAC systems include wireless controllers as standard. Optional wired controllers can be purchased as an accessory. When installing wired controllers for RAC indoor units, installation of a wired controller sub-PCB is required which is also required when connecting to central controllers. When ordering wired controller kits through Samsung HVAC (AR-WRP2, AR-WRS02), the sub-PCB, wired controller, and wire harness are included so only the interface module will need to be additionally purchased.

This document is for general reference only. Refer to installation manuals for complete installation instructions. Samsung HVAC maintains a policy of ongoing development, specifications are subject to change without notice.

### Sub PCB Installation

- The sub-PCB will install inside the indoor unit. Refer to the indoor unit installation manual for full details.

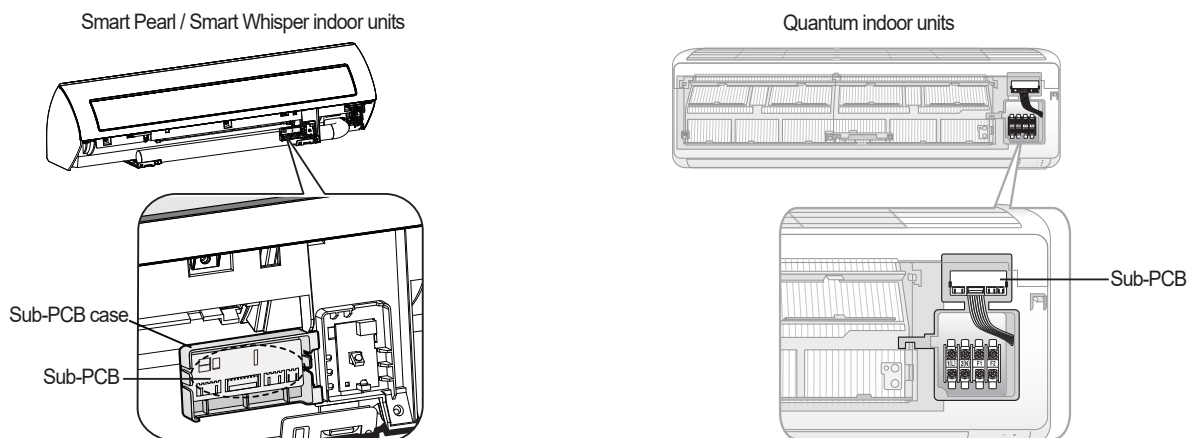

### Enabling indoor unit central control

Samsung RAC units are configured to not allow central control as standard. The installer must enable central control for each indoor unit before tracking the central controller. For AR\*\*\*\*\*W\* systems, central control can be enabled via wired or wireless control.

### System programming with wireless controller (single option setting method)



- Remove the batteries and wait for the screen to go blank. While holding the temperature up and down buttons, replace the batteries.
- Use the FAN DOWN button to adjust the segment on the left and the FAN UP button to adjust the segment on the right to enter code into the wireless controller as shown on the images above.
- Press MODE to advance to the next page (noted by "Auto", "Cool", and "Dry").
- Once the numbers shown above are entered into the controller, press the power button several times while pointing remote at the indoor unit.
- All 6 segments must be entered to prevent undesired programming and operation.
- Remove batteries. After the screen goes blank, replace batteries and cover to return to normal operation.
- Cycle power to system.

### System programming with MWR-WE13 wired controller

- Hold SET and Delete for 5 seconds to enter service mode.
- Press the up arrow button, select Main Menu 4.
- Press the right arrow button to advance.
- Press the up arrow button to select sub menu 3.
- Press the right arrow to advance.
- Enter the code above into the data bit section using the up, down, and right arrow buttons.
- Press the right arrow button to advance.
- Once entered, press SET to save.
- Press ESC twice to exit the settings section.
- Cycle power to the system.

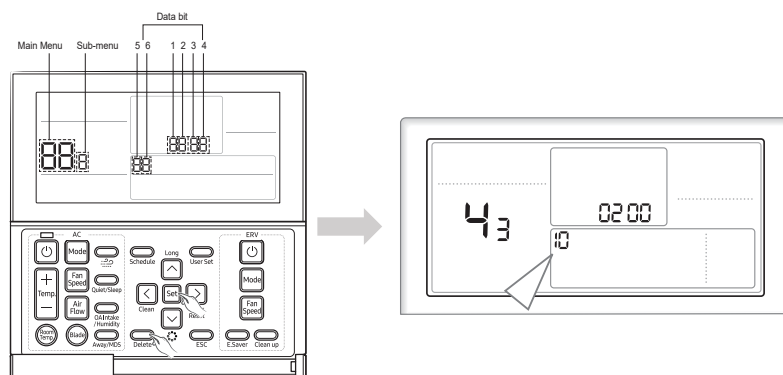

### System programming with MWR-WH02 wired controller

- Hold FILTER RESET and TEMP for 5 seconds to enter service settings mode.
- "1" will display. Menu 18 is where indoor unit option codes can be reviewed/changed. Press the up arrow button until "18" is displayed.
- Press SET.
- Press the up arrow button and down arrow buttons to change the value of the flashing segment.
- Press SET arrow button to advance to the next segment.
- Press MODE to go to the next page. Pages are represented with a "0", "1", "2", and "3" as the first segment.
- After the code has been entered, scroll through all 4 pages to verify that the code was entered correctly.
- Press the power button (above the fan up button) to send the code to the indoor unit.
- Cycle power to the system.

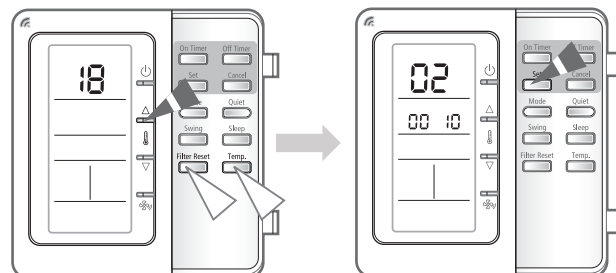

This document is for general reference only. Refer to installation manuals for complete installation instructions. Samsung HVAC maintains a policy of ongoing development, specifications are subject to change without notice.

## Single zone wall unit installation example without wired controller (central control integration)

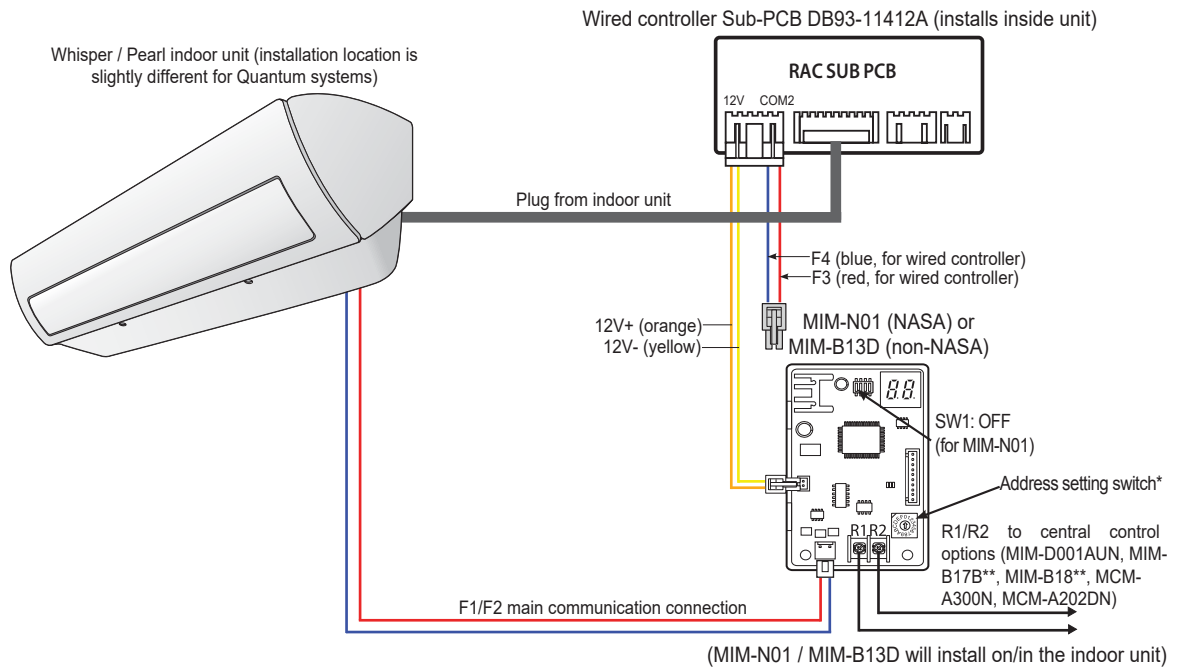

## Single zone wall unit installation example with wired controller (central control integration)

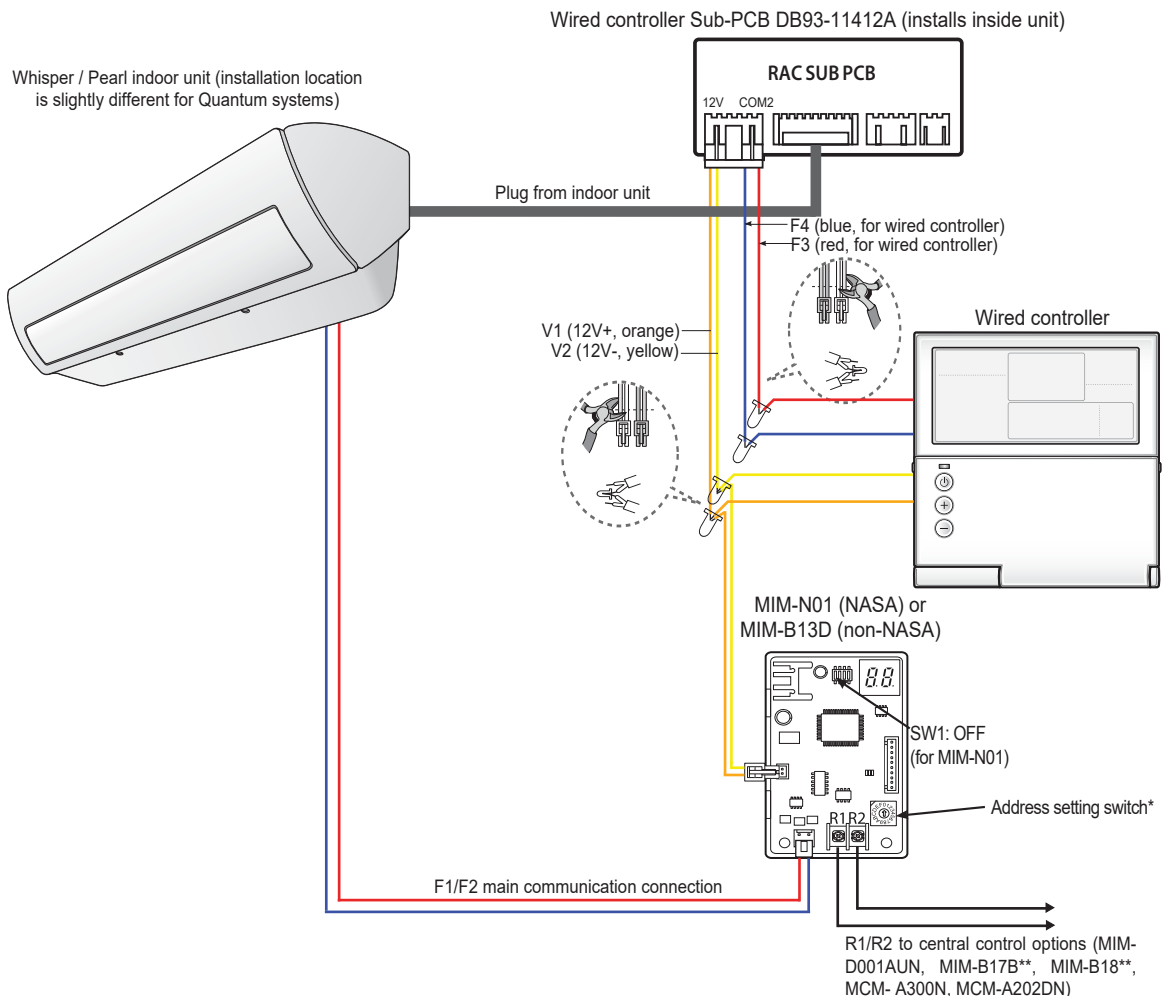

NOTE: (MIM-N01 / MIM-B13D will install on/in the indoor unit)