

Date: 05/01/2017

Subject: MWR-SH10N wired controller - Temperature Compensation Adjustment

Models: CAC and DVM S Indoor Units

MWR-SH10N Wired Controller - Temperature Compensation Adjustment

Some applications may require temperature compensation adjustment if displayed Room Temperature does not represent actual Room Temperature. Adjustment can be made in the Service Mode.

1. To enter Service Mode, press and hold the top right corner of the of the display (hidden button) for 3 seconds and release. A "0" should now display on the screen.
2. Use the [+] button to change the "0" to a "3" and press the [OK] button. A "1" should now display on the screen.

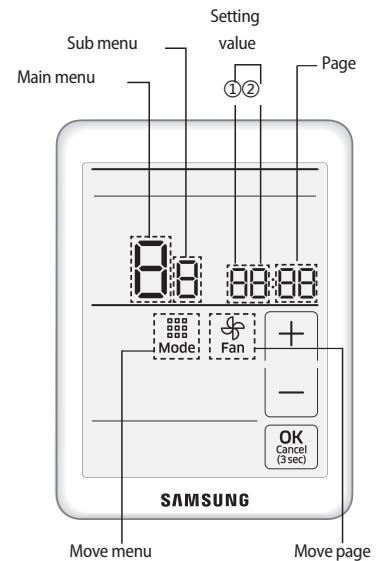
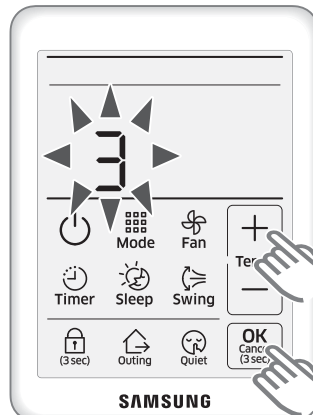
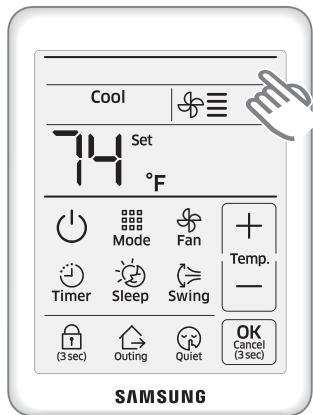

3. Press the [Mode] button and a small "1" should display beside the large "1". Use the [+] button to change the small "1" to a "5".
4. Press the [Mode] button and page ":01" should display to the right. The first 2 digits are the current temperature reading. This is displayed in Celsius.
5. Press the [Fan] button to change the page from ":01" to ":02". Page ":02" will allow you to increase or decrease temperature compensation by [1°C] by pressing the [+] or [-] button. To change in increments of 0.1°C, press [Fan] button to change to page ":03". If the temperature viewed in the controller is 2°F higher, you will want to lower the segment by "1". The "00" before the page number will then display "-01".

****Programming Tip: 1°C = 1.8°F****

6. Press the [OK] button to save the changes. Press and hold the [OK] button for 3 seconds to exit the Service Mode